

Instructions for adding a Kyocera printer to user stations

Search settings —> Printers and scanners —> Press add a printer or scanner

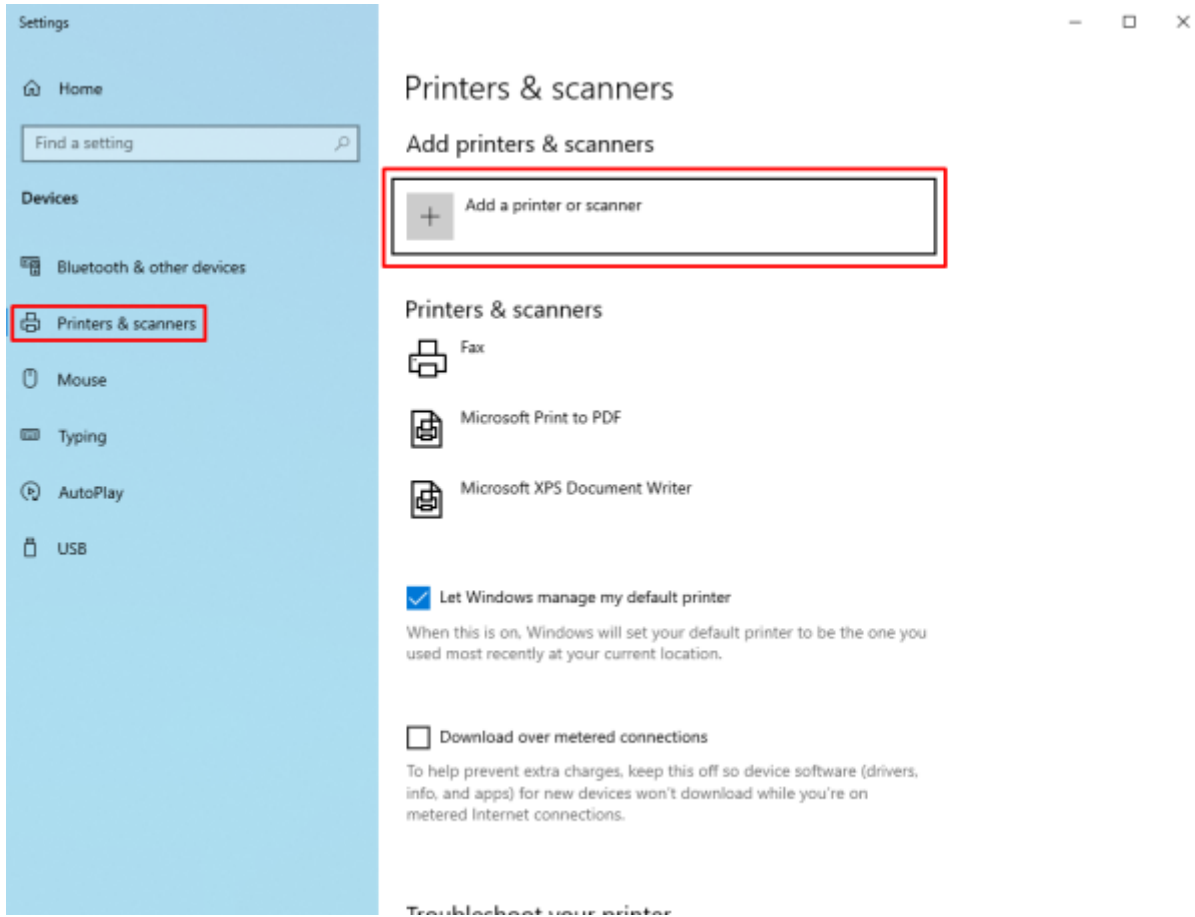

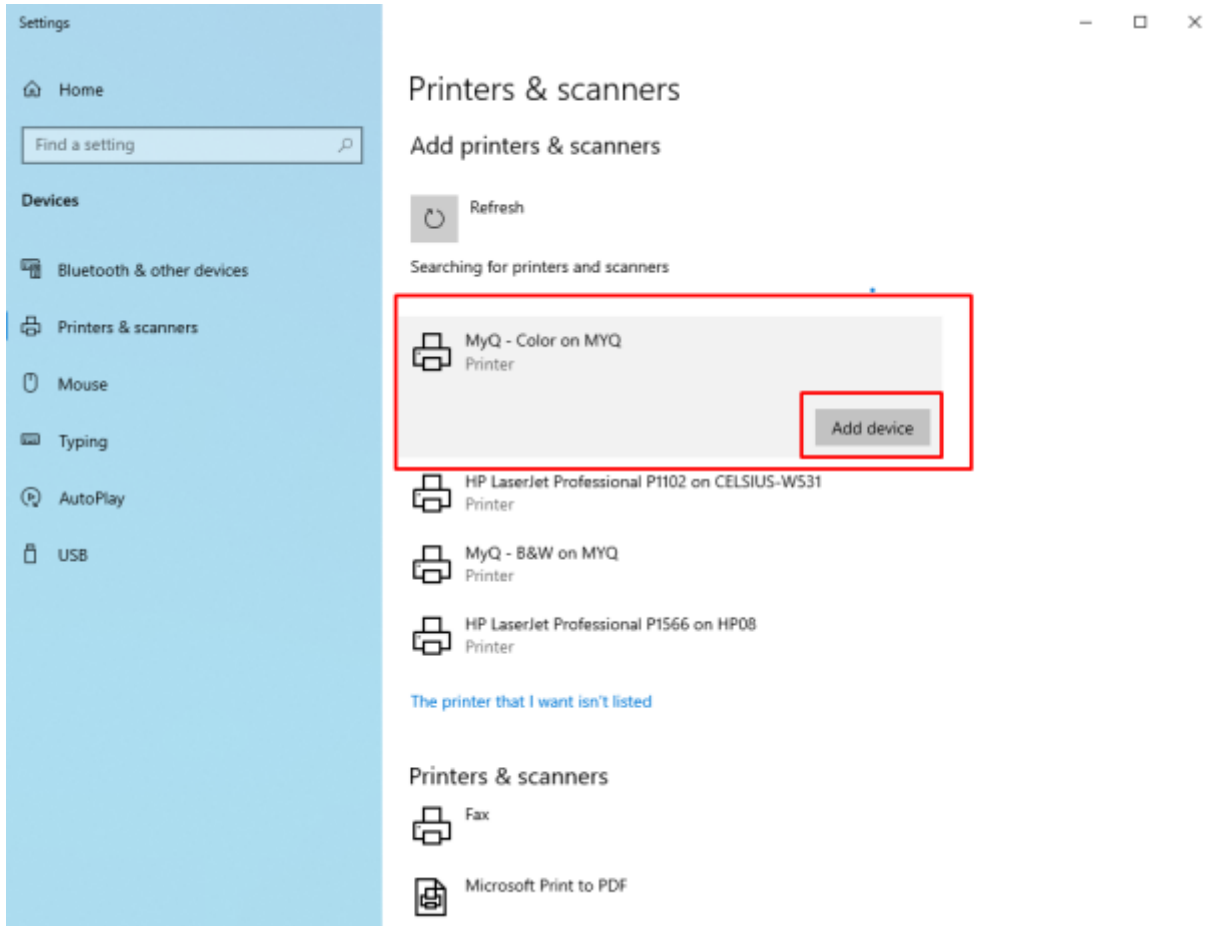

From: <https://itinfo.cerge-ei.cz/> - **CERGE-EI Infrastructure Services**

Permanent link: https://itinfo.cerge-ei.cz/doku.php?id=public:print:cerge_desktops&rev=1682425636

Last update: **2023-04-25 12:27**

