

Instructions for adding a Kyocera printer to user stations

Press Start button → Devices and Printers → Add a Printer

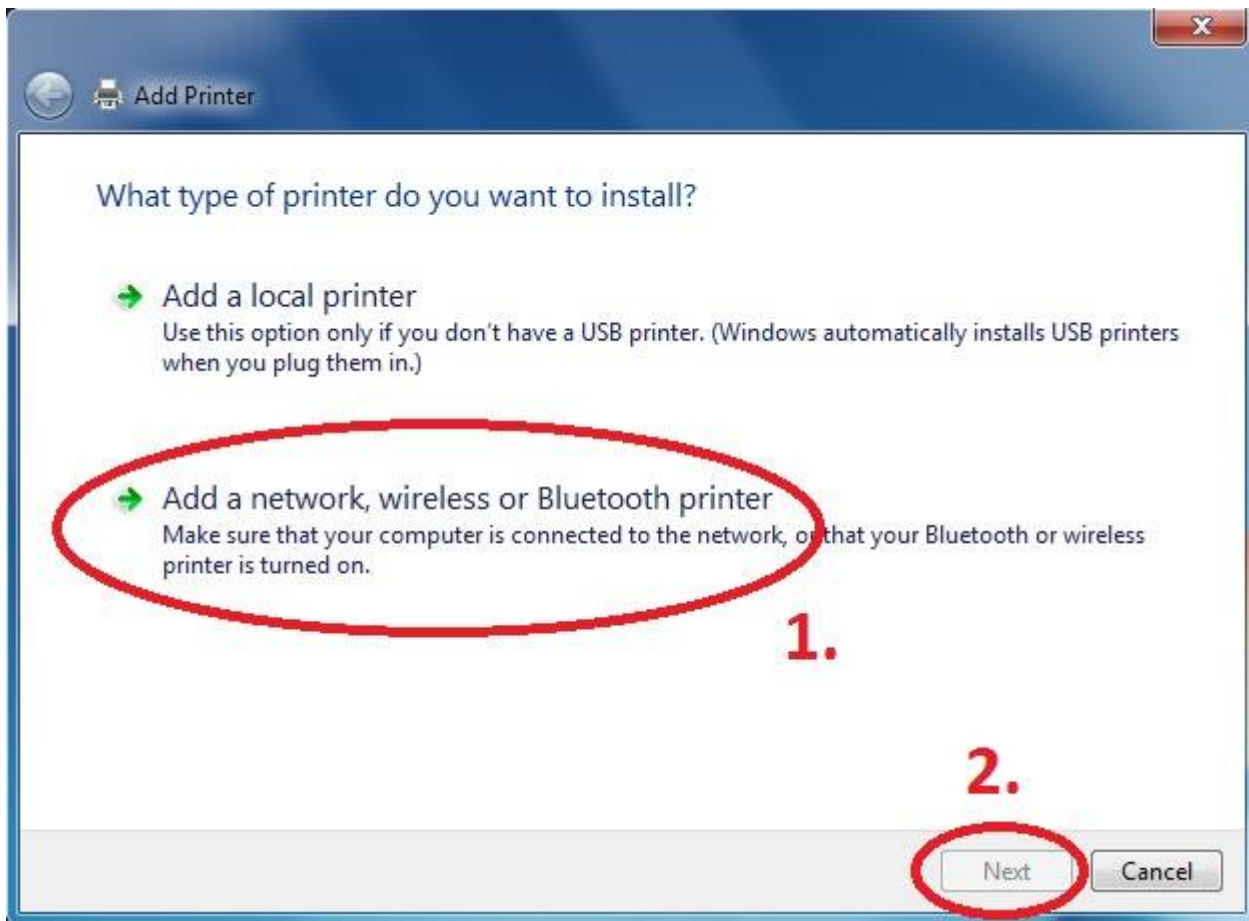

Add a network printer



Choose MyQ - Color and/or MyQ - B&W printer

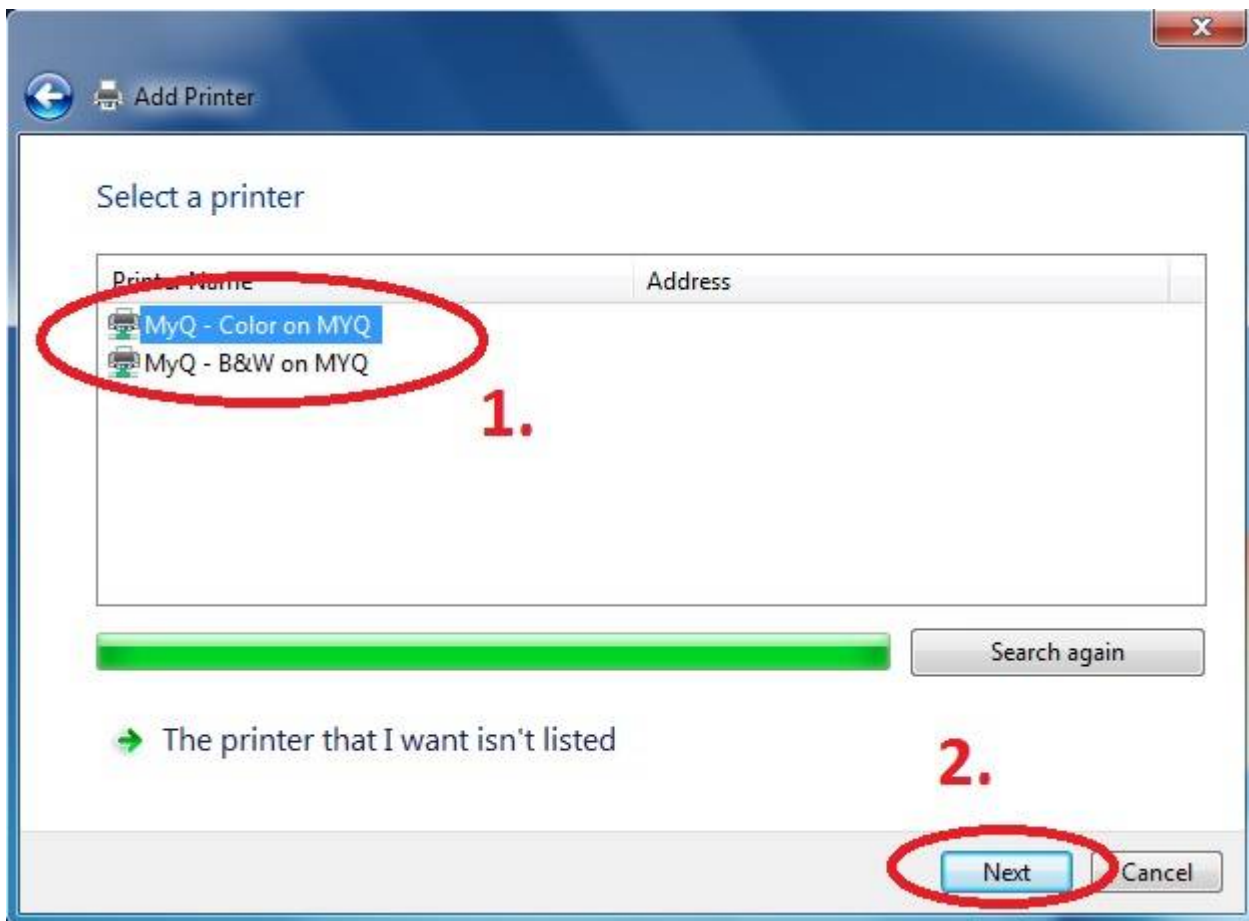

From:
<https://itinfo.cerge-ei.cz/> - **CERGE-EI Infrastructure Services**

Permanent link:
https://itinfo.cerge-ei.cz/doku.php?id=public:print:cerge_desktops&rev=1515669062

Last update: **2018-01-11 11:11**

