

Email Client Settings for iPhone (Generic iPhone Example)

For details about IMAP/SMTP settings see [general email client settings](#) article.

create new account - **Zimbra**

Press Settings > Mail > Add Account > Other > Add Mail Account



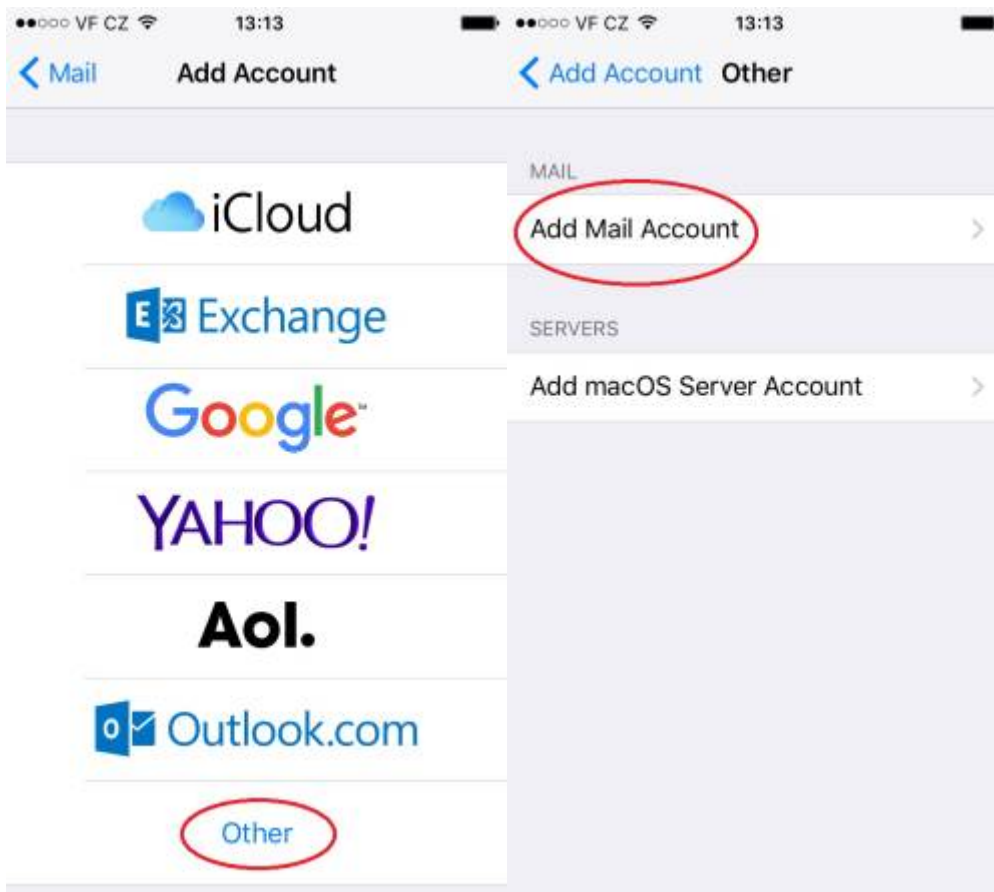

Fill your credentials > Incoming and Outgoing server > Press Advanced and change Incoming Settings

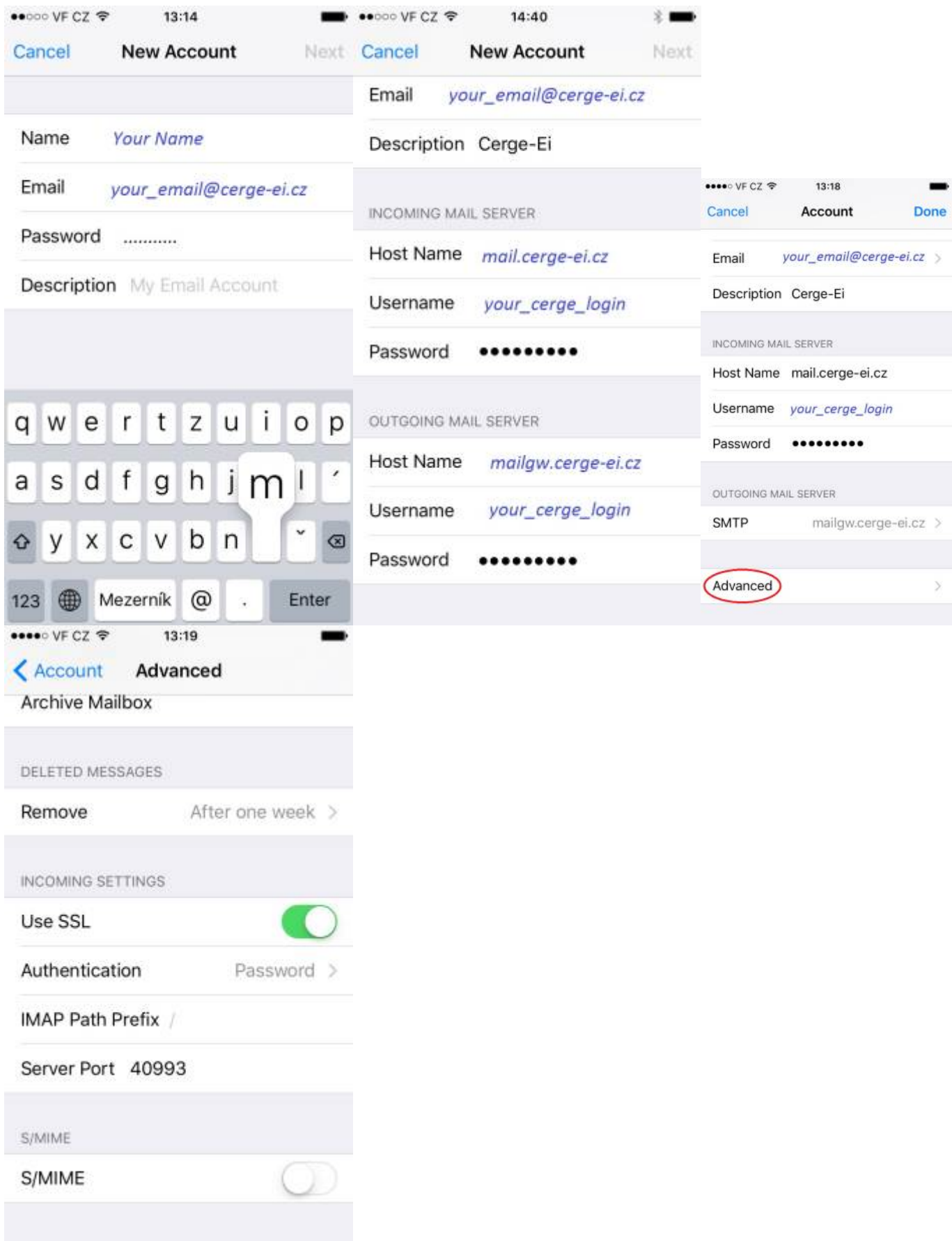

Check Outgoing mail server settings

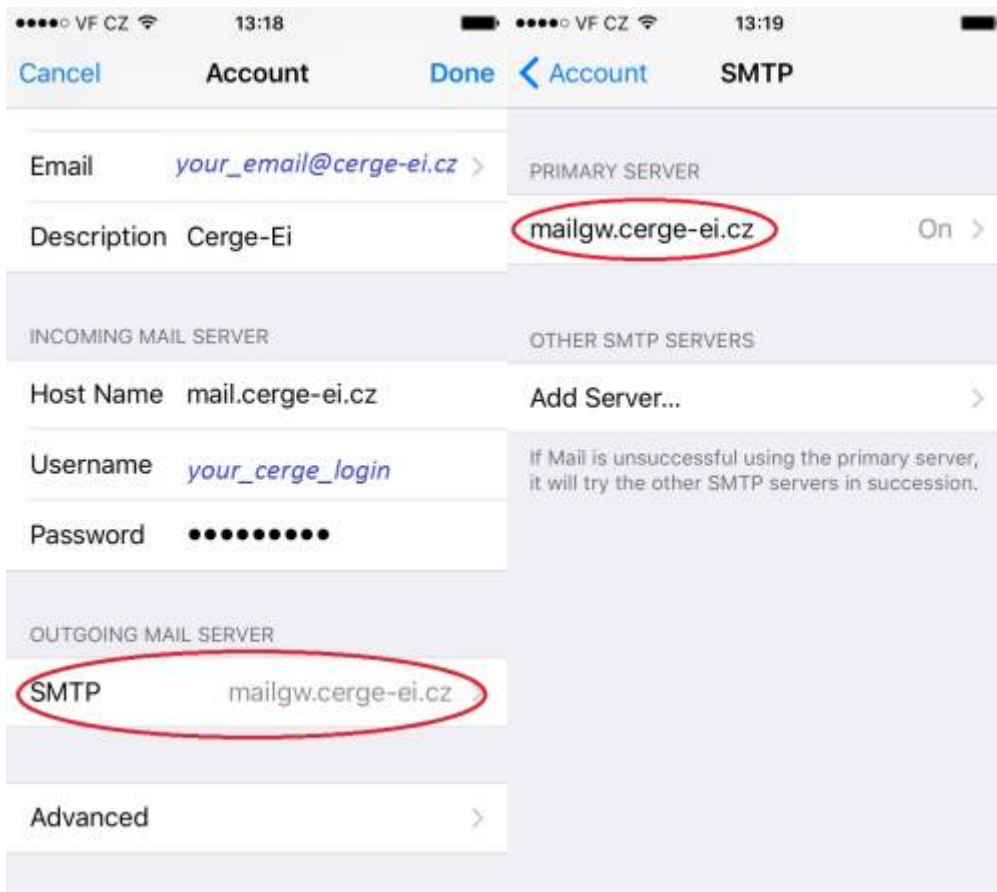

From:

<https://itinfo.cerge-ei.cz/> - **CERGE-EI Infrastructure Services**

Permanent link:

https://itinfo.cerge-ei.cz/doku.php?id=public:emai:client_settings_iphone&rev=1537192321

Last update: **2018-09-17 13:52**

